

打印机 入门指南

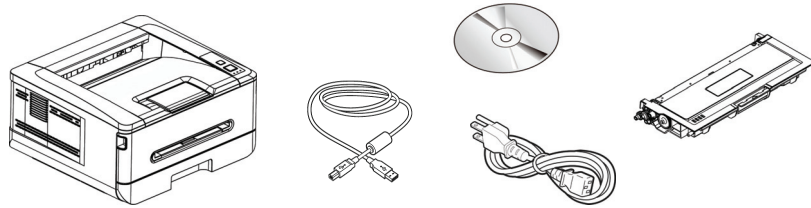

251-1304-0V100

1 包装内容



2 安装墨粉盒

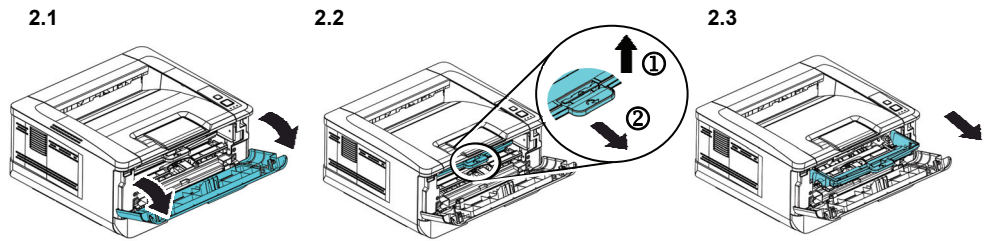

2

2.4

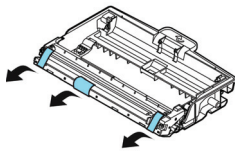

2.5

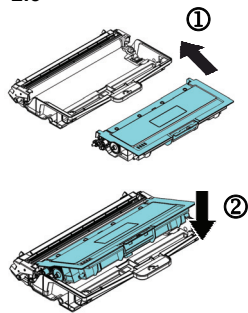

2.6

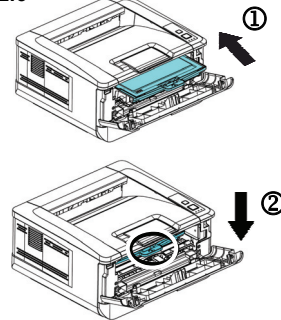

2.7

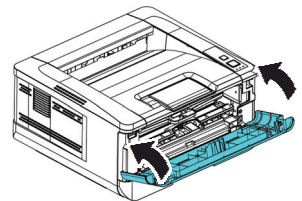

3 将纸张装入主要纸盒

3.1

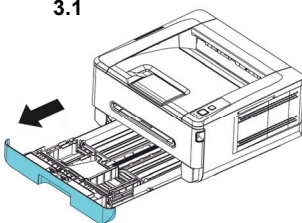

3.2

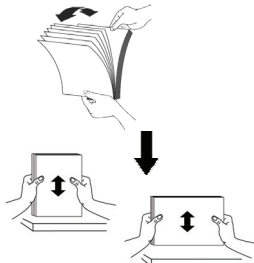

3.3

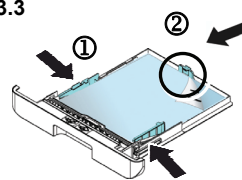

3.4

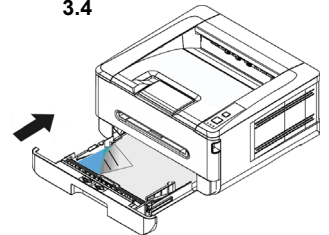

4 将纸张装入手动纸盒

4.1

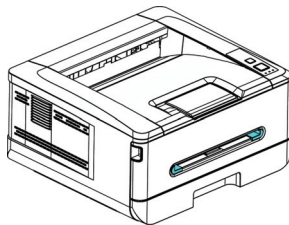

4.2

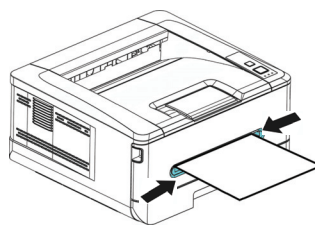

5 连接电源

5.1

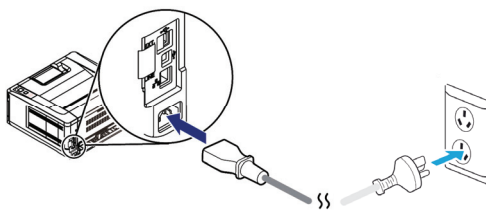

5.2

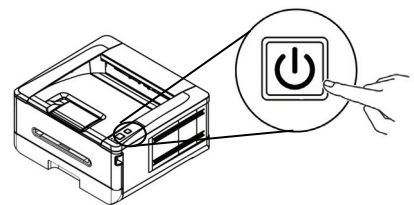

6 透过网络连接计算机

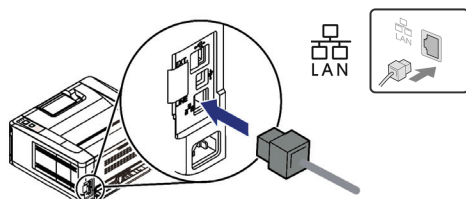

→要获取 IP 地址，请长按取消按钮。

7 安装打印机驱动程序

7.1

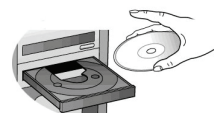

7.2

安装打印机驱动程序
浏览使用手册

8 透过 USB 端口连接计算机

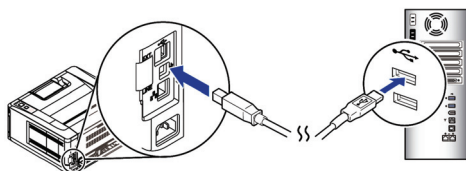

! 更多网络设置及操作的细节，请参考光盘内的使用手册。



→网络打印机：本机台预设的 IP 地址为 192.168.1.100，可在本产品内建的网页将机台预设的 IP 改为您所指定的 IP 地址。开启浏览器，在网址字段内输入 192.168.1.100，本产品内建的网页会开启。依序点选[属性]>[网络]>[以太网网络]，在[以太网网络]页面中输入您所指定的 IP 地址，再按[更新]来完成即可。